

Product specification for inductive components

Form: MF04.05 (F108)
Revision: 01

Client:	MAGNETEC	Magnetec P/N:	M-924	Magnetec A/N:	53190
Client's P/N:	M-924	PS Index:	01	PS Revision:	02
Subject:	CT Wandler				

1. Mechanical Outline

Nominal equivalent round core:

17,5 x 10 x 7

Finished product dimensions:

OD \leq **18,4**

ID \geq **8,9**

H \leq **8**

[dimensions] = mm

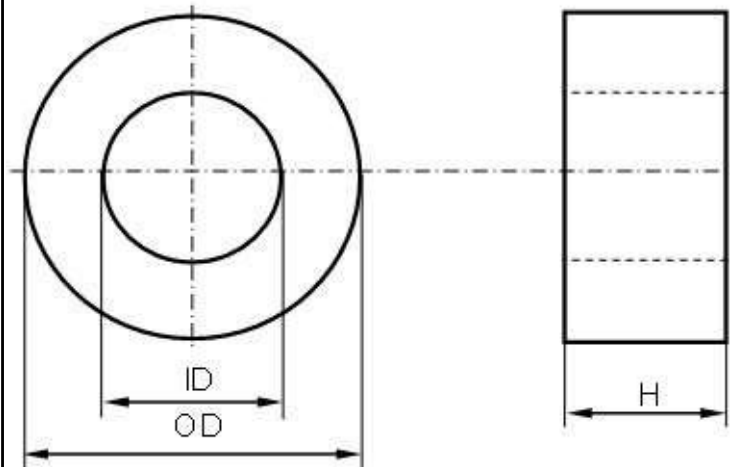

2. Core data (nominal values)

Core material:	NANOPERM®	$L_{Fe} = 4,19 \text{ cm}$	$A_{Fe} = 0,21 \text{ cm}^2$
Permeability level:	~165000	@ frequency 120 Hz	@ H peak 1 mA/cm

3. Inspection values (at room temperature, unless otherwise stated)

Measured value	Measurement limits	Frequency	$l_{eff} \times N$ [mA x turn]
AL μH]	40 - 124	120 Hz	1,95
AL	66 - 140	120 Hz	4,05
AL	70 - 155	120 Hz	15,9
AL	99 - 240	120 Hz	26,4

4. Core finishing

Type:	Epoxy coated
Marking:	None
Packaging:	pcs. per layer; layers per carton box; PU = pcs.

5. Comments

Visit http://www.magnetec.de/fileadmin/pdf/pb_ds.pdf for further information.

Index / Revision	Alteration	Date
01 / 01	First issue	11.07.2016
01/02	The measerement limits are changed.	2020.05.27

Created:	I. Váradi 27.05.2020	Approved (Techn):	F. Zámboorszky 08.07.2020	Approved (Quality):	Sz. Ilcsik 01.07.2020	Released:	D. Tóth
-----------------	-------------------------	--------------------------	------------------------------	----------------------------	--------------------------	------------------	---------

Disclosing the specification to third parties or using its content without written permission from MAGNETEC is strictly forbidden and every offender is liable to pay the corresponding damages