



Client:	MAGNETEC	Magnetec P/N:	M-388	Magnetec A/N:	12374
Client's P/N:	/	PS Index:	05	PS Revision:	05
Subject:	EMC Wandler			Type:	

### 1. Mechanical Outline

Nominal core dimensions:

**10 x 7 x 5**

Finished product dimensions:

OD  $\leq$  11,4

ID  $\geq$  5,4

H  $\leq$  6,3

[dimensions] = mm

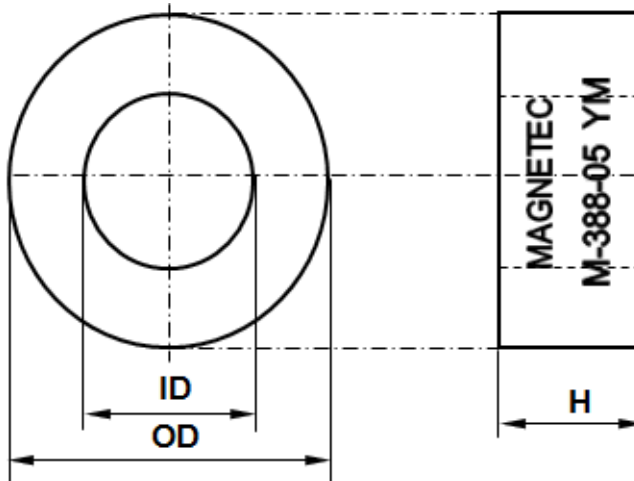

### 2. Core data (nominal values)

Core material:	NANOPERM®	$L_{Fe} = 2,64$ cm	$A_{Fe} = 0,06$ cm <sup>2</sup>
Permeability level:	60 000	@ frequency 10 kHz	@ H peak 2,68 mA/cm

### 3. Inspection values

	Measured value	Measurement limits	Frequency	leff x N [mA x turn]
AL [ $\mu$ H]		11,7 - 24,2	10 kHz	5
AL [ $\mu$ H]		4 - NA	100 kHz	5

### 4. Core finishing

Type:	Cased
Marking:	MAGNETEC M-388-05 YM (YM = Year/Month), acc. to IEC 60062 6.1.1
Packaging:	128 pcs. per layer; 10 layers per carton box ; PU = 1280 pcs.

### 5. Comments :



Index / Revision	Alteration	Date
03 / 01	Product Specification	18.10.2006
03 / 02	PU = 2850 pcs.	09.11.2007
04 / 03	Case welding	04.03.2008
05 / 04	Case lid gluing; ID $\geq$ 5,4 mm; PU = 1280 pcs.	30.06.2008
05 / 05	100kHz lower limit defined	14.11.2014

Created:	Z. Palánki	Approved (Techn):	F. Záborszky	Approved (Quality):	J. Gulyás	Released:	T. Trupp
	14.11.2014		27.01.2015		27.01.2015		27.01.2015