



Client:	MAGNETEC	Magnetec P/N:	M-475	Magnetec A/N:	12325
Client's P/N:	/	PS Index:	01	PS Revision:	03
Subject:	EMC Wandler			Type:	

### 1. Mechanical Outline

Nominal core dimensions:

**50 x 40 x 25**

Finished product dimensions:

OD ≤ 53,6

ID ≥ 35,9

H ≤ 29,5

[dimensions] = mm

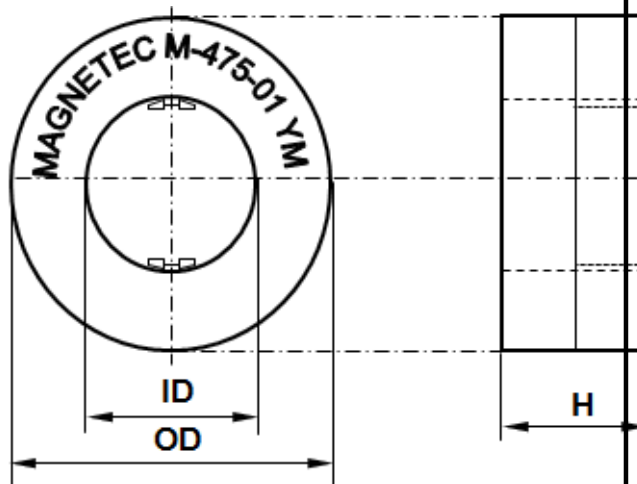

### 2. Core data (nominal values)

Core material:	NANOPERM®	$L_{Fe} = 14,08 \text{ cm}$	$A_{Fe} = 0,91 \text{ cm}^2$
Permeability level:	30.000	@ frequency 10 kHz	@ H peak 3,01 mA/cm

### 3. Inspection values

	Measured value	Measurement limits	Frequency	$l_{eff} \times N$ [mA x turn]
	AL [μH]	18,7 - 37,5	10 kHz	30
	AL [μH]	9,3 - NA	100 kHz	30

### 4. Core finishing

Type:	Cased
Marking:	MAGNETEC M-475-01 YM (YM = Year/Month), acc. to IEC 60062 6.1.1
Packaging:	10 pcs. per layer; 3 layers per carton box ; PU = 30 pcs.

### 5. Comments:



Index / Revision	Alteration	Date
01 / 01	Product Specification	01.02.2007
01 / 02	PU = 30 pcs.	14.05.2007
01 / 03	100kHz lower limit defined	24.11.2014

Created:	Z. Palánki	Approved (Techn):	F. Záborszky	Approved (Quality):	J. Gulyás	Released:	T. Trupp
	24.11.2014		09.03.2015		09.03.2015		09.03.2015