



Client:	MAGNETEC	Magnetec P/N:	M-670	Magnetec A/N:	12694
Client's P/N:	/	PS Index:	01	PS Revision:	01
Subject:	EMC Wandler			Type:	K

1. Mechanical Outline

Nominal core dimensions:

30 x 20 x 10

Finished product dimensions:

OD \leq 32,7

ID \geq 17,8

H \leq 12,6

[dimensions] = mm

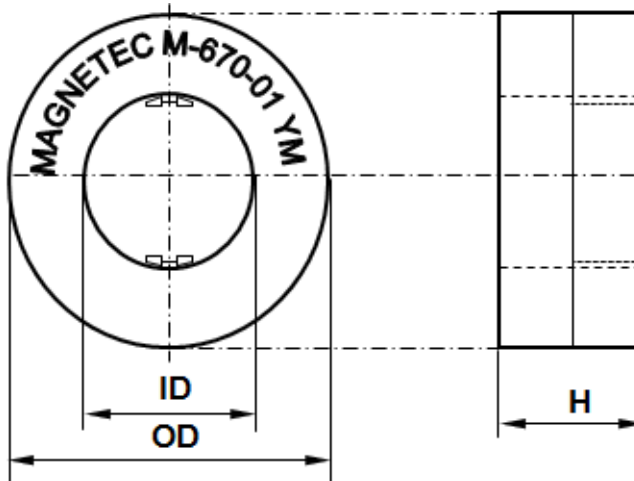

2. Core data (nominal values)

Core material:	NANOPERM®	$L_{Fe} = 7,75 \text{ cm}$	$A_{Fe} = 0,375 \text{ cm}^2$
Permeability level:	2 000	@ frequency 10 kHz	@ H peak 3 mA/cm

3. Inspection values

	Measured value	Measurement limits	Frequency	leff x N [mA x turn]
AL [μ H]		0,85 - 1,7	10 kHz	16,5
AL [μ H]		0,85 - NA	100 kHz	16,5

4. Core finishing

Type:	Cased
Marking:	MAGNETEC M-670-01 YM (YM = Year/Month), acc. to IEC 60062 6.1.1
Packaging:	35 pcs. per layer; 6 layers per carton box ; PU = 210 pcs.

5. Comments:



Index / Revision	Alteration	Date
01 / 01	First issue	01.08.2014

Created:	Z. Palánki	Approved (Techn):	F. Zámorszky	Approved (Quality):	J. Gulyás	Released:	T. Trupp
	01.08.2014		01.09.2014		01.09.2014		01.09.2014